

6.1 LUANDA (LAD)

DABS Luanda is a Line Station.

The **Station office** is located in the Airport of Luanda – (Angola).

Address **DABS Luanda**
BESTFLY FLIGHT SUPPORT LDA HANGAR
Aeroporto Internacional 4 de Fevereiro
Terminal de Voos Executivos, Luanda
Luanda@dassault-business.com
T. +351 210 322 824

The office is located within the facilities of Luanda airport with restricted access and required means and equipment to perform the works specified in 6.10.2.

The Office is located inside BESTFLY FLIGHT SUPPORT LDA HANGAR. The room measures 4 meters by 6 meters. The room is climate controlled at 20 degrees and electronically secured by restricted access passes. Office is organised as follows:

- Office area with computer equipment, phone, scanner necessary for consulting technical documents and to do administrative work. The computer is set up to have access to DABS's servers. DABS IT department makes a daily backup of all the information stored in its servers.
- Cabinets are properly identified for storage of components, consumables and tools.

6.1.1 PERSONNEL

These personnel are nominated in regards to 145.A.30(b) and 145.A.30(g). These personnel is considered as authorised personnel in regards to 145.A.25(d).

6.1.1.1 Management

Management

Stations & MCC Maintenance Director	Vasco ARAÚJO
VP Safety, Quality & Compliance	Thierry BARRE
Stations - Compliance monitoring Manager	Ines RODRIGUES

Personnel in Line station

Line Station Responsible	Joel FONSECA
Certifying staff	Refer to DA-0103

6.1.1.2 Support staff and certifying staff

Refer to DA-0103 for details of privilege.

Details of scope and validity are issued by the **SQ department**.

In case of unavailability of the B1 or B2 staff, certifying staff from Stations could be sent to the Line Station.

6.1.1.3 Additional staff

Refer to DA-0103.

6.1.2 SCOPE OF WORK

6.1.2.1 Rating

A1	Aircraft Model	Designation/ limitation	Eng.	DABS Luanda	Base	Line
				Maintenance level – Limitation Limited up to and incl.		
Bombardier	BD-700-1A10	Global Express	BR710	Monthly checks	no	Yes*
		Global XRS		500H		Yes
	BD-700-1A11	Global 6000		500H		Yes
		Global 5000		500H		Yes
Dassault	Falcon 900	Falcon 900	TFE731-5	2M	no	Yes
		Falcon 900B	PW307A	2M	no	Yes
	Falcon 7X	Falcon 8X	PW307D	2M	no	Yes

*Work could be performed on this Aircraft Type only if **maintenance data** is provided by the Customer or TC Holder before work (i.a.w. 145.A.45(a)). Tools, GSE, Support and Certifying Staff are available.

Privileges include:

- Servicing / minor works / Troubleshooting / Rectification
- maintenance works as described in limitation
- Minor repair and modification
- APU & Engines on wings Inspections and works

Scope level includes Airframe, Engine and APU:

- **Due items** and **Limited scheduled maintenance works** from maintenance programme.
- Limitation for line maintenance event is work down time **up to 25 hours of man-hours**.
- **Form WAAS (DA-0141)** to be used for assessment in case of **work below described scope limitation**. maintenance project is limited to down time below **1 week and/or above 100 hours of man-hours**. NAA approval/acceptance is required.

Approval Perimeter (other authorities)

Refer DA-0108.

6.1.2.2 Components

N/A

6.1.3 DOCUMENTATION

Name	media
AMM	Web access
EMM	
APU MM	
Standard Practice Manual	
CMM *	

* CMM access is limited to those products and activities specified in the Capability list. **(DA-0105)**

6.1.4 (SUB)CONTRACTORS

See Provider List **(DA-0104)** for approved:

- Subcontractor list
- Metrology provider list
- Contractor list

6.1.5 HOUSING AND FACILITIES

The **Station office** is located in the Airport of Luanda – (Angola).

Address is described page 6.9.1.

6.1.5.1 General Situation

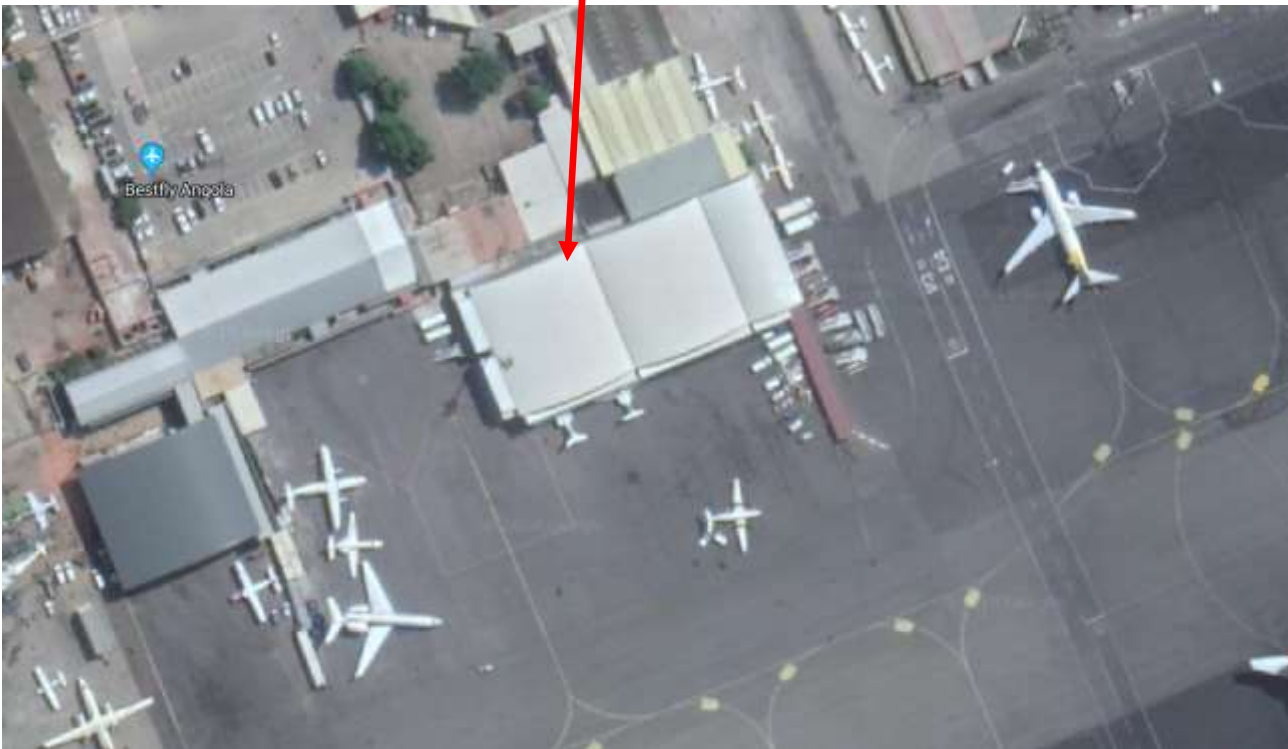

6.1.5.2 General Description / Hangar

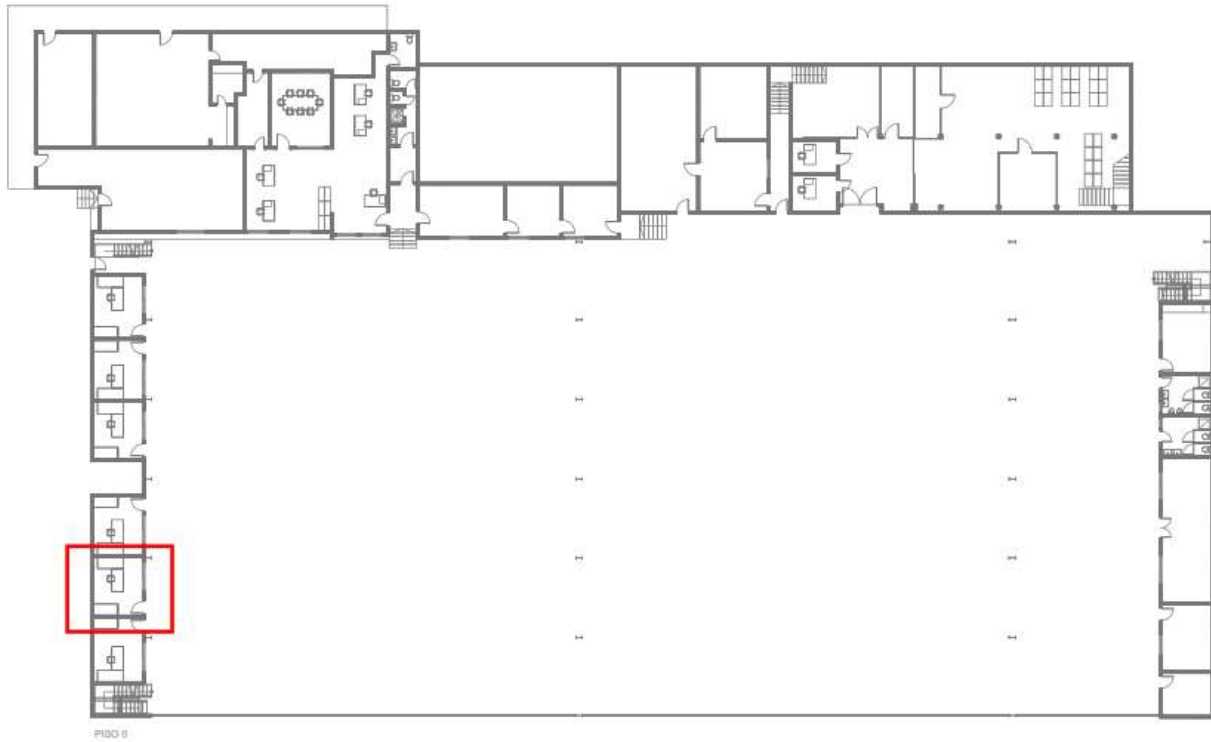

Part STATION - Chapter LUANDA (LAD)

6.1.6 PICTURES

6.1.6.1 Hangar Area



Part STATION - Chapter LUANDA (LAD)

6.1.6.2 Office



Part STATION - Chapter LUANDA (LAD)

6.1.6.3 Tool & Equipment



Part STATION - Chapter LUANDA (LAD)

6.1.6.4 Spare parts and ingredients



Part STATION - Chapter LUANDA (LAD)

6.1.6.5 Servicing

